

NOTES:

1. A POSITIVE GOING VOLTAGE AT TERMINAL 2 RELATIVE TO TERMINAL 1, CAUSES A DECREASE IN PRESSURE AT THE SOUND OUTLET.

2 LOCATED FROM TWO SURFACES FOR CUSTOMER CONVENIENCE. ONLY APPLICABLE FROM ONE SURFACE, NOT TO BE USED TOGETHER. HORIZONTAL LOCATION FOR TERMINAL CENTERED TO $\pm 0,17$ [.007].

3 RECEIVERS WIRED IN ELECTRICAL PARALLEL WHEN CONNECTED TO TERMINAL 1 AND TERMINAL 2.

4 VENT HOLES (2 PLS.) DO NOT BLOCK OR FILL WITH DEBRIS.

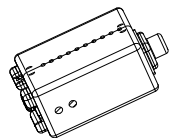
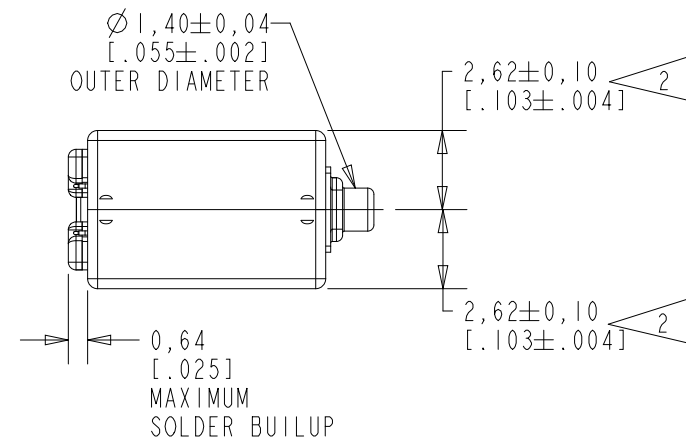
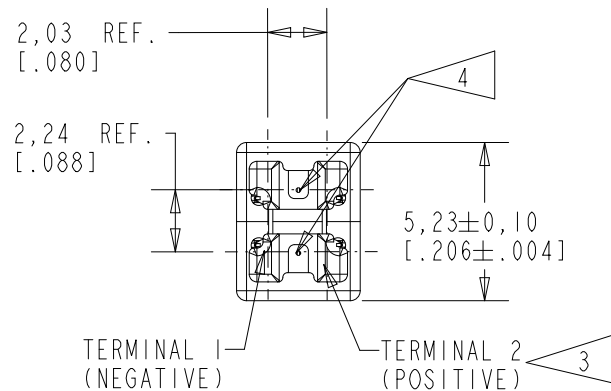
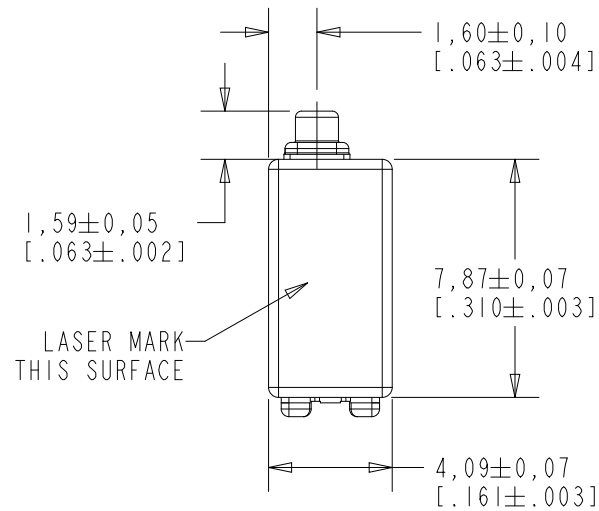

NOMINAL WEIGHT
.55 GRAMS

DIMENSIONS IN MILLIMETERS [INCHES]

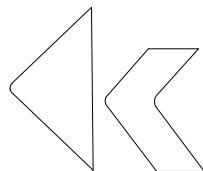

knowles

REVISION	ECR NO.	IMP. DATE	SCALE	DR. BY	DATE
			4:1	CVC	07-01-22
				CH. BY	DATE
A	P10006439	07-01-22		GJP	07-06-22
RELEASE LEVEL		REVISION	DO NOT SCALE DRAWING	APP. BY	DATE
Active		A	DIMENSIONS IN MILLIMETERS [INCHES]	GJP	07-06-22
TITLE:			RDI-34727-000		
RECEIVER			SHEET 1.1		
OUTLINE DRAWING			KE111ASIZE.FRM		

KE111ASIZE.FRM

Rev: B

THE RDI-34727-000 IS A PAIR OF BALANCED ARMATURE RECEIVERS WITH BACK VENT AT TERMINAL PADS FOR USE IN EARPHONE APPLICATIONS.

TYPE I

RDI-34727-000

SHT 2.1
RoHS COMPLIANT

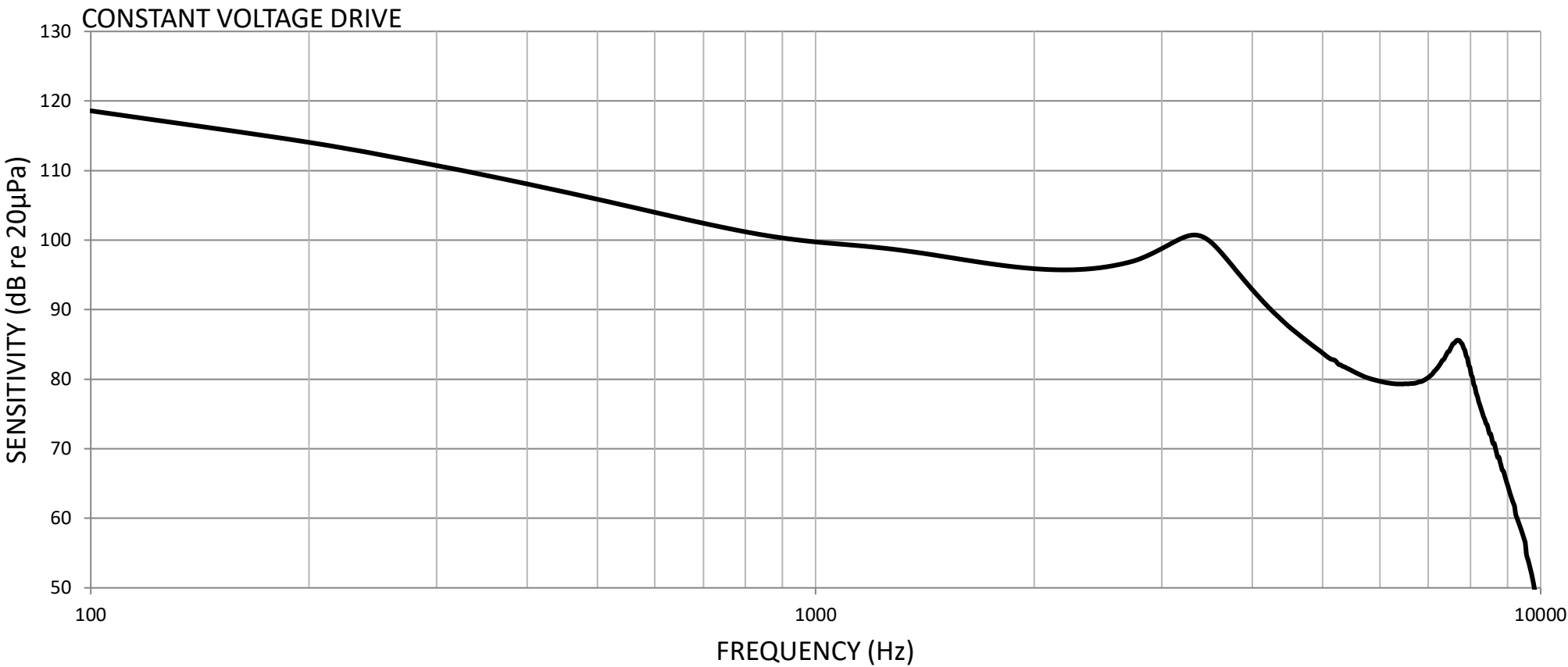

ACOUSTICAL

SENSITIVITY: DEVICE WILL PRODUCE THE SPL LISTED BELOW WITH THE TEST CONDITIONS DESCRIBED IN TABLE 3. NOMINAL SENSITIVITY AT 500Hz IS dB RELATIVE TO 20 µPa. ALL OTHER VALUES IN dB RELATIVE TO THE SENSITIVITY AT 500Hz.

LIMIT TYPE	FREQUENCY (Hz)	MINIMUM	NOMINAL	MAXIMUM
REL	200	5.0	8.0	11.0
REF	500	-3.0	106.0	3.0
REL	1000	-9.0	-6.0	-3.0
PEAK 1	3000-3600	-8.0	-5.0	-2.0
VALLEY 1	5900-6900	-30.0		
PEAK 2	6900-8500	-23.0	-20.0	-17.0

TABLE 1

TOTAL HARMONIC DISTORTION: DEVICE WILL NOT EXCEED TOTAL HARMONIC DISTORTION LEVELS LISTED BELOW:

FREQUENCY (Hz)	AC DRIVE (Vrms)	BIAS	LIMIT (%)
1/3*PEAK 1	0.118	0	5
1/2*PEAK 1	0.118	0	5
1/3*PEAK 1	0.236	0	10
1/2*PEAK 1	0.236	0	10

TABLE 2

TEST CONDITIONS

NOMINAL SOURCE VOLTAGE	0.118 Vrms
SOURCE IMPEDANCE	<1 OHM
TUBING	TUBELESS< KNOWLES TOOL NUMBER T8688
COUPLER CAVITY	711 EAR SIMULATOR, GRAS RA0045 (IEC-60318-4)

NOTE: THE ACOUSTIC PERFORMANCE IS MEASURED WITH VENT UNBLOCKED INTO THE OPEN AIR.

TABLE 3

KNOWLES RESERVES THE RIGHT TO MAKE CHANGES TO IMPROVE RELIABILITY AND PERFORMANCE OF THE PRODUCT.

ELECTRICAL

DC RESISTANCE @ 20°C	8.7 OHM ± 10%
IMPEDANCE @ 500 Hz	12.5 OHM ± 15%
IMPEDANCE @ 1 kHz	17.2 OHM ± 15%

TABLE 4

ISOLATION: CASE WILL BE ELECTRICALLY ISOLATED FROM THE COIL CIRCUIT.

MECHANICAL

PORT LOCATION: 11S
SOLDER TYPE: ROHS COMPLIANT, SAC 305

KNOWLES CORPORATION

REVISION	C.O. #	IMPLEMENTATION DATE	RELEASE LEVEL	REVISION
			Active	A
A	P10006439	07-01-22		
WHEN TEST LIMITS ARE USED TO ESTABLISH INCOMING INSPECTION ACCEPTANCE/REJECTION CRITERIA, CORRELATION OF TEST EQUIPMENT WITH KNOWLES IS ALSO REQUIRED FOR ELIMINATION OF EQUIPMENT AND TEST METHOD VARIATION.			DR BY	DATE
			CVC	07-01-22
			CK BY	DATE
			GJP	07-06-22
RECEIVER PERFORMANCE SPECIFICATION			APP BY	DATE
			GJP	07-06-22
			SHT 2.1	